

DETALIU A  
scara 1:5

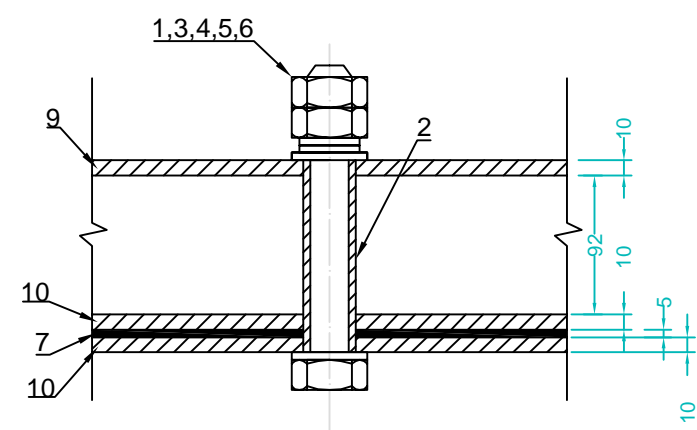

8 - 10 x 142 x 144  
scara 1:5

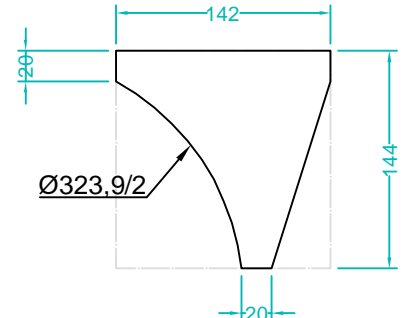

15 - 10 x 50 x 400  
scara 1:10

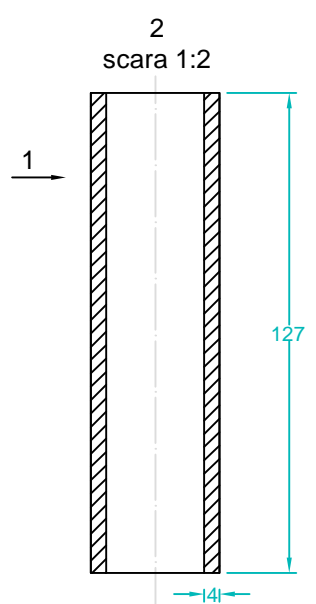
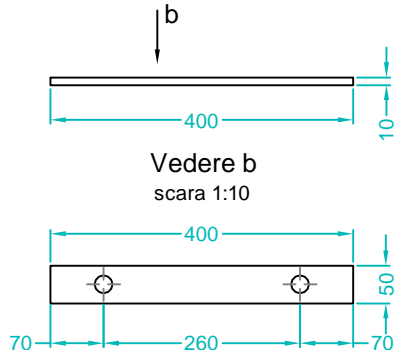

SECTIUNE 1 - 1  
scara 1:2

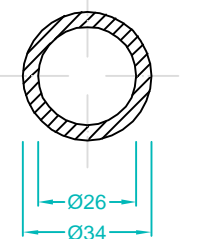

7 - 5 x 500 x 700  
scara 1:10

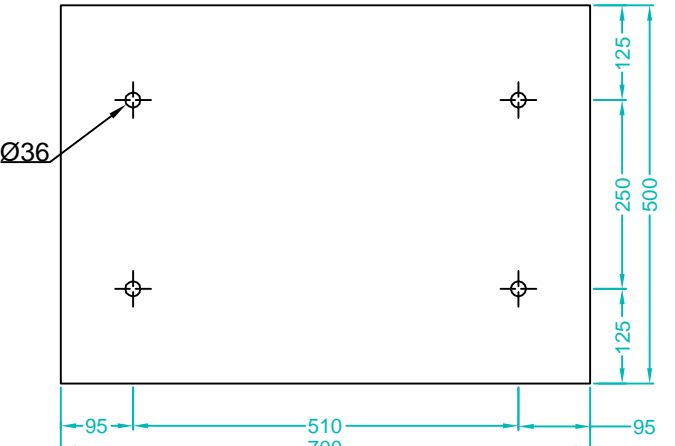

1 - 3 x 26 x 50  
scara 1:10

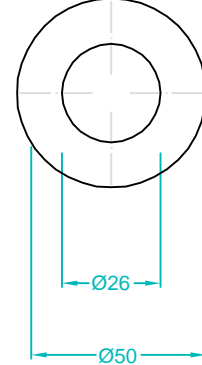

9 - 10 x 450 x 650  
scara 1:10

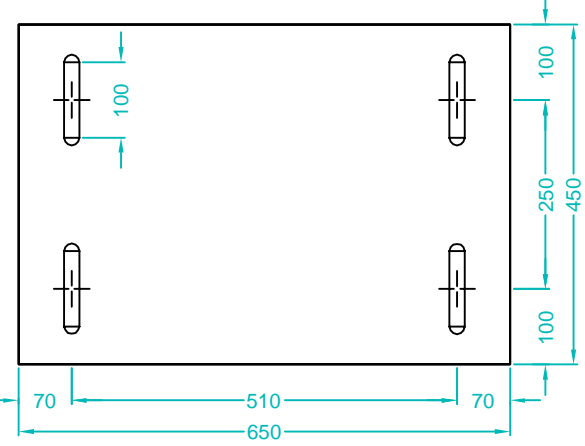

12 - 30 x 30 x 490  
scara 1:10

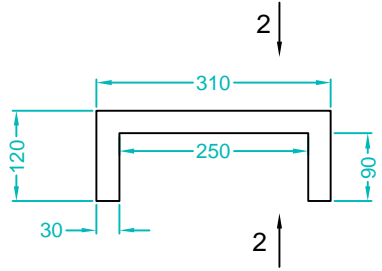

10 - 10 x 450 x 650  
scara 1:10

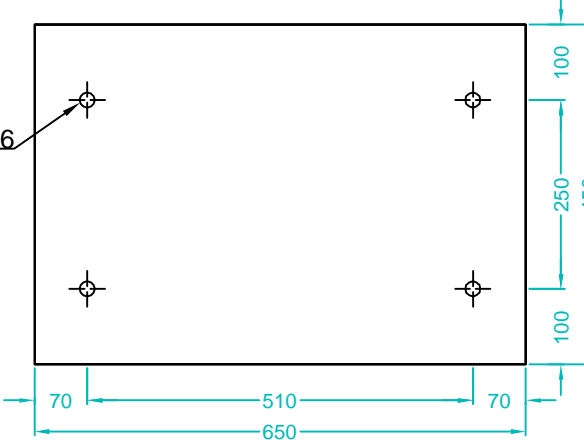

13  
scara 1:10

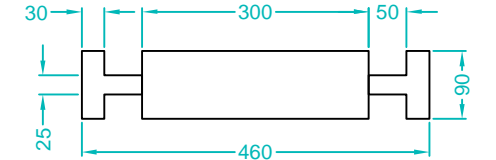

d - d  
scara 1:10

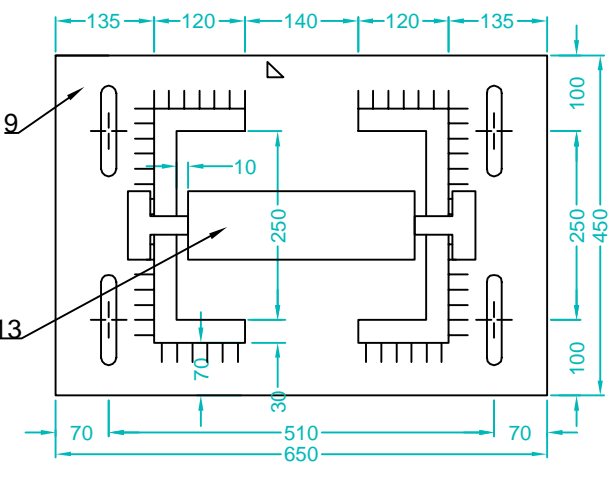

NOTA  
Grosimea cordoanelor de sudura - 0.7 mm;  
Imbinarile sudate conf. C150-88 - "D";  
Clasa de calitate a lucrarii conf. STAS 767/0-88 - "B";

Total pentru n buc. [Kg] =							1	368.08
Total pentru 1 buc. [Kg] =								368.08
SUDURA 3% Kg								10.72
17	TABLA GROASA	S235JR	SR EN 10029-94	8 x 400 Øext. = 422	16.55	2	33.10	
16	TABLA GROASA	S235JR	SR EN 10029-94	10x200x150	2.35	4	9.40	
15	TABLA GROASA	S235JR	SR EN 10029-94	10 x 50 x 400	1.57	8	12.56	
14	TABLA GROASA	S235JR	SR EN 10029-94	8 x 400 Øext. = 524	20.55	2	41.10	
13	OTEL ROTUND	S235	334-88	460 x Ø90	22.97	2	45.94	
12	OTEL PATRAT	S235	334-88	30 x 30 - 550	3.89	8	31.12	
11	TABLA GROASA	S235JR	SR EN 10029-94	10x200x230	3.61	4	14.44	
10	TABLA GROASA	S235JR	SR EN 10029-94	10x450x650	22.77	4	91.08	
9	TABLA GROASA	S235JR	SR EN 10029-94	10x450x650	22.77	2	45.54	
8	TABLA GROASA	S235JR	SR EN 10029-94	10x142x144	1.57	8	12.56	
7	PLACA TEXTOLIT	TEXT.		5 x 500 x 700	2.45	2	4.90	
6	SURUB		SR ISO4016-94	M24-170	0.661	16	10.58	
5	SAIBA PLATA		5200/4-91	A24	0.029	16	0.46	
4	SAIBA GROWER		7666/2-80	AG24	0.024	16	0.38	
3	PIULITA		922-89	M24	0.11	32	3.55	
2	BUCSA TEXTOLIT	TEXT.		Ø34 x 4-127	0.060	8	0.48	
1	SAIBA TEXTOLIT	TEXT.		Ø50 x 26 x 3	0.010	16	0.16	
Poz	Denumire	Material	STAS	Dim. [mm]	Kg/buc	Nr. buc	Masa totala [Kg]	

Verificator/ Expert	Nume	Semnatura	Cerinta	Referat / Expertiza Nr. / Data			
S.C. SNIF PROIECT S.A. Targoviste Numar de inmatriculare J15/925/2005				Beneficiar: CONPET S.A. PLOIESTI			Pr. nr. 309
Specificatie	Nume	Semnatura	Scara: 1:10 1:5 1:2	Inlocuire conducta de transport titer Ø12" si Ø14" Carpatani-Ploiesti in zonele: Crivat-Catunul pe o lungime de cca. 550m+30m foraj orizontal subtraversare DN 1A Bucuresti-Ploiesti, loc. Ghimpati - traversare rau Colentina pe o lungime de cca. 500m si loc. Slantu Gheorghe - Crevedia Mica, pe o lungime de cca. 1.100m, cu un total de 2.180m pe lin			Faza PT+CS+DE
Sef proiect	Ing. Costea Paul						
Desenat	Ing. Radu Florin		Data: 2015				Pl. nr. 23
Sef proiect	Ing. Costea Paul						